

# LEX TEC INC

## DATALEX

## STANDBY SERIES NP12-12 (12V12AH/20HR)

### Specifications

Nominal Voltage	12V	
Nominal Capacity(20hr)	12AH	
Dimension	Length	151±2mm(5.94inch)
	Width	98±2mm(3.86inch)
	Height	94±2mm(3.70inch)
	Total Height	98±2mm(3.86inch)
Approx Weight	Approx. 3.45kg(+3%)	
Terminal Type	F1/F2	
container Material	ABS(UL-94HB)	
Internal Resistance	Approx.18mΩ	
Rated Capacity	12.00AH	(20hr, 1.75V/cell,25°C/77°F)
	11.5AH	(10hr, 1.75V/cell,25°C/77°F)
	10.2AH	(5hr, 1.75V/cell,25°C/77°F)
	9.6AH	(3hr, 1.75V/cell,25°C/77°F)
	7.0AH	(1hr, 1.75V/cell,25°C/77°F)
Max. Discharge Current	200A(5S)	
Nominal Operating Temp. Range	Limit of operating temperature ( minimum -05°C and +45°C)	
Cycle Use	Charge Current Less Than 0.25CA	
	14.1V~14.7V@25°C(77°F)Temp. Coefficient -30mV/°C	
Floating Use	13.5V~13.8V@25°C(77°F)Temp. Coefficient -20mV/°C	
	40°C	103%
Capacity affected by Temperature	25°C	100%
	0°C	86%
	-15°C	65%
Self-discharge	3 month	Remaining capacity: 91%
	6 month	Remaining capacity:82%
	12month	Remaining capacity:65%



### Terminal Type

#### Terminal F1

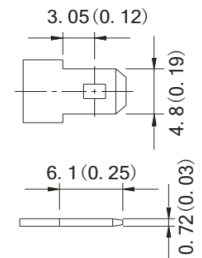

#### Terminal F2

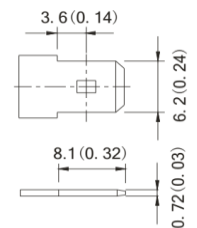

### Constant Power Discharge at 25°C(77°F)

F.V/Time	5min	10min	15min	30min	1h	2h	3h	4h	5h	6h	10h	20h
1.80V/cell	75.7	52.3	36.2	22.4	13.2	7.73	5.88	4.68	3.88	3.32	2.17	1.14
1.75V/cell	77.1	53.3	36.9	22.9	13.5	7.88	5.99	4.77	3.96	3.38	2.21	1.16
1.70V/cell	79.5	54.8	39.1	23.8	13.7	8.02	6.10	4.85	4.03	3.44	2.25	1.18
1.67V/cell	81.8	56.4	42.4	25.1	13.9	8.10	6.17	4.90	4.07	3.47	2.27	1.19
1.60V/cell	84.1	58.0	44.6	26.2	14.0	8.19	6.23	4.96	4.11	3.51	2.29	1.21

### Constant Current Discharge at 25°C(77°F)

F.V/Time	5min	10min	15min	30min	1h	2h	3h	4h	5h	6h	10h	20h
1.80V/cell	38.8	26.8	18.6	11.5	6.79	3.96	3.01	2.40	1.99	1.70	1.11	0.59
1.75V/cell	39.6	27.3	18.9	11.7	6.92	4.04	3.07	2.44	2.03	1.73	1.13	0.60
1.70V/cell	40.7	28.1	20.0	12.2	7.03	4.11	3.12	2.79	2.49	1.76	1.15	0.61
1.67V/cell	41.9	28.9	21.8	12.9	7.11	4.16	3.16	2.51	2.51	1.78	1.16	0.61
1.60V/cell	43.1	29.8	22.9	13.4	7.18	4.20	3.19	2.54	2.54	1.80	1.18	0.62

### LEX TEC

160 Don Park Road, Unit 4 Markham, Ontario L3R 1C3

TEL 905-475-9979 FAX 905-475-9970

[www.lextec.com](http://www.lextec.com)

**Discharge Characteristics**

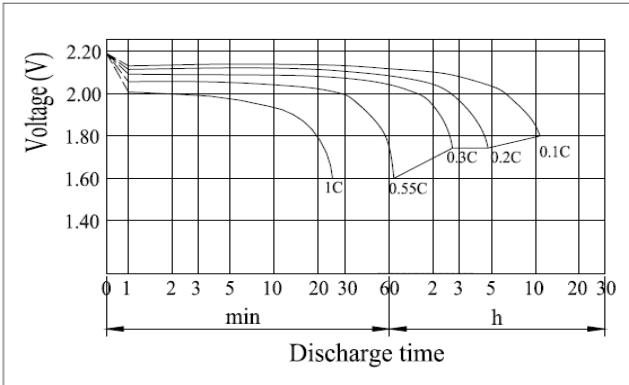

**Float Charging Characteristics**

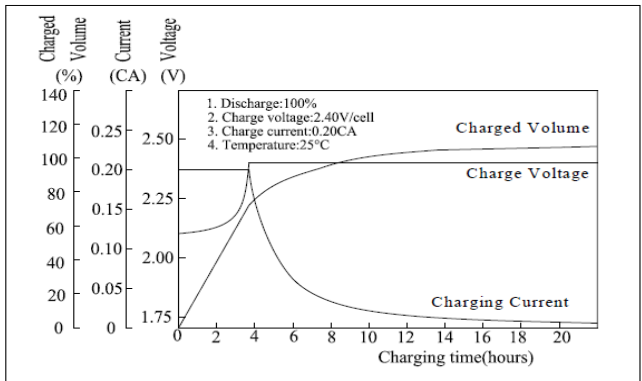

**Floating Life on Temperature**

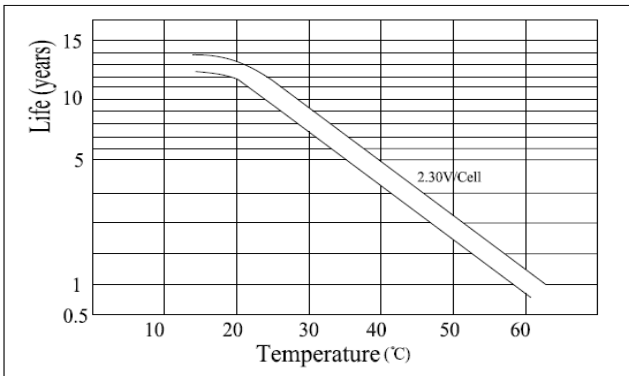

**Self Discharge Characteristics ( 25°C(77°F) )**

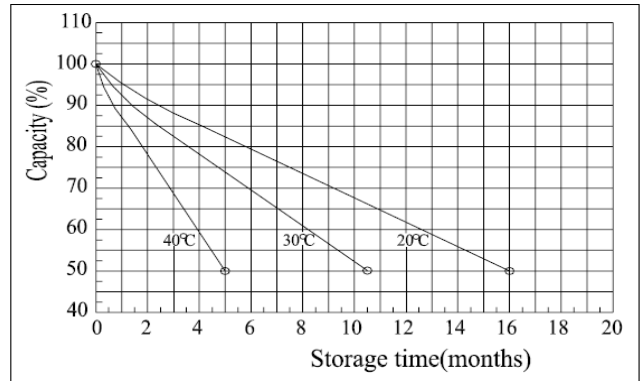

**Temperature Effects in Relation to Battery Capacity**

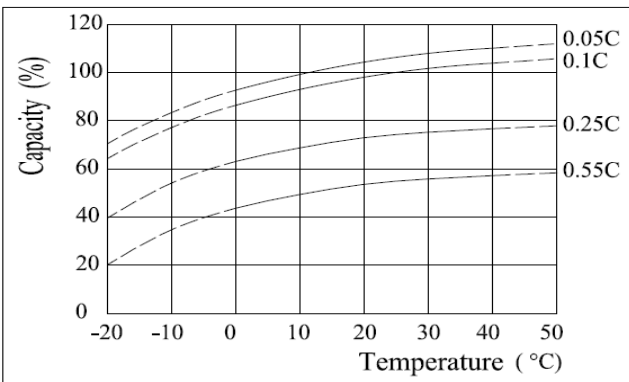

**Cycle Life Relation to Depth of Discharge**

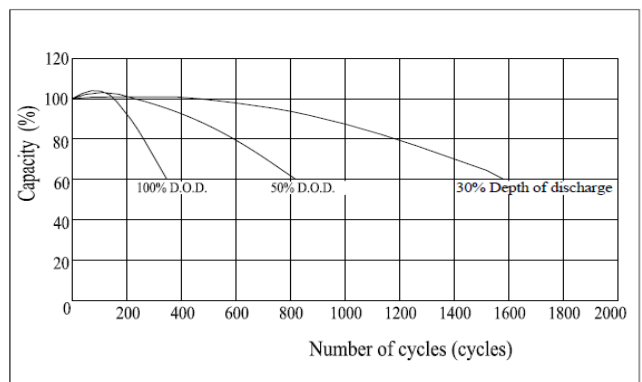

**LEX TEC**  
**160 Don Park Road, Unit 4 Markham, Ontario L3R 1C3**  
**TEL 905-475-9979 FAX 905-475-9970**  
[www.lextec.com](http://www.lextec.com)

